

## Specifications

Model	7512
Color	White cover and base
Capacity	120 mL
Run Time	Up to 5 hours
Features	Color Rotating/Fixed/Off Color Rotating LED Lights: Blue, Green, and Red
Misting Modes	Continuous/Off
Coverage	Up to 1,000 square feet
Rated Power	12W
Adapter Power	100-240V, 24V, 0.5A

## Troubleshooting

SYMPTOM	CAUSE	SOLUTION
No mist	Using distilled or purified water	Use tap water (unfiltered).
	Unit is out of water	Add additional water.
No mist or little mist	Unit needs to be cleaned. Oils are clinging to ceramic disc or sensor	Clean unit as advised in instructions with clean water, dry with cloth and clean ceramic disc/sensor with brush or swab.
	Water level is higher than max level line	Clean unit and add water 1/2 way to fill line and add more water after getting mist.
Blinking lights	Water level indicator is dirty	Clean unit as advised. Pay particular attention to the sensor/disc inside the bottom of unit.
Unit will not stop running even though empty	Water level indicator is dirty	Clean unit as advised. Pay particular attention to the sensor/disc inside the bottom of unit.

**CAUTION: Keep away from children and pets.**

This diffuser has a 1-year manufacturer guarantee.  
Please call customer service at 1-888-548-0040 for assistance.  
Do not return to the retailer.

Distributed by NOW Foods  
Bloomington, IL 60108, USA  
[nowfoods.com/essential-oils](http://nowfoods.com/essential-oils)

Customer Service 888-548-0040

Product of China



**now**<sup>®</sup>  
solutions

## NOW<sup>®</sup> Essential Oils

NOW<sup>®</sup> Essential Oils are genuine reflections of the botanicals from which they're borne. When properly diffused, these botanical extracts can encourage wellness, tranquility and even inspiration. Our essential oils are highly concentrated and identity verified to ensure quality, and we use only fresh botanicals bursting with vitality and beneficial compounds. For 30 years NOW has been offering pure, premium essential oils, and our expertise, strict attention to detail, meticulous extraction methods, and focus on safety and purity are what set NOW Essential Oils apart. We take the necessary steps to ensure our oils are brought to you in a manner that's scientifically and environmentally responsible.



For more information visit [nowfoods.com/essential-oils](http://nowfoods.com/essential-oils).

## Ultrasonic Oil Diffuser

[nowfoods.com/essential-oils](http://nowfoods.com/essential-oils)



instructions & care



## Essential Oil Recipes

Add the following oils to a diffuser and enjoy:

### Balancing Blends

#### Daily Balance

- 2 drops of NOW® Geranium Oil
- 2 drops of NOW® Rose Absolute Oil
- 2 drops of NOW® Clary Sage Oil

#### Head Ease

- 2 drops of NOW® Lavender Oil
- 2 drops of NOW® Peppermint Oil
- 2 drops of NOW® Chamomile Oil

### Purifying Blends

#### Purifying Room

- 1 drop of NOW® Tea Tree Oil
- 1 drop of NOW® Grapefruit Oil
- 10 drops of NOW® Lemon Oil

#### Spring Cleaning

- 10 drops of NOW® Lemongrass Oil
- 5 drops of NOW® Lemon Oil
- 1 drop of NOW® Eucalyptus Oil

### Uplifting Blends

#### Summer Fun

- 2 drops of NOW® Lavender Oil
- 2 drops of NOW® Peppermint Oil
- 2 drops of NOW® Grapefruit Oil

#### Energizing

- 1 drop of NOW® Peppermint Oil
- 1 drop of NOW® Rosemary Oil
- 2 drops of NOW® Cinnamon Cassia Oil

### Relaxing Blends

#### Peace of Mind

- 5 drops of NOW® Lavender Oil
- 3 drops of NOW® Chamomile Oil

#### Calming Night

- 2 drops of NOW® Cypress Oil
- 2 drops of NOW® Lavender Oil
- 2 drops of NOW® Marjoram Oil

### Romance Blends

#### Love is in the Air

- 1 drop of NOW® Patchouli Oil
- 3 drops of NOW® Jasmine Absolute Oil
- 5 drops of NOW® Geranium Oil

#### Things are Just Rosey

- 1 drop of NOW® Geranium Oil
- 15 drops of NOW® Rose Absolute Oil

Thank you for your purchase of NOW® Solutions Ultrasonic Oil Diffuser. Please read the instructions carefully before using.

### How it works

NOW® Solutions Ultrasonic Oil Diffuser uses high frequency ultrasonic technology that vibrates cool water inside the unit creating an ultra fine mist. When essential oils are added, they are immediately dispersed into the air, providing immediate healthful benefits and helping to ionize the air. It can be used in a bedroom, living room, office area or anywhere you want to create a relaxing environment.

### What's included

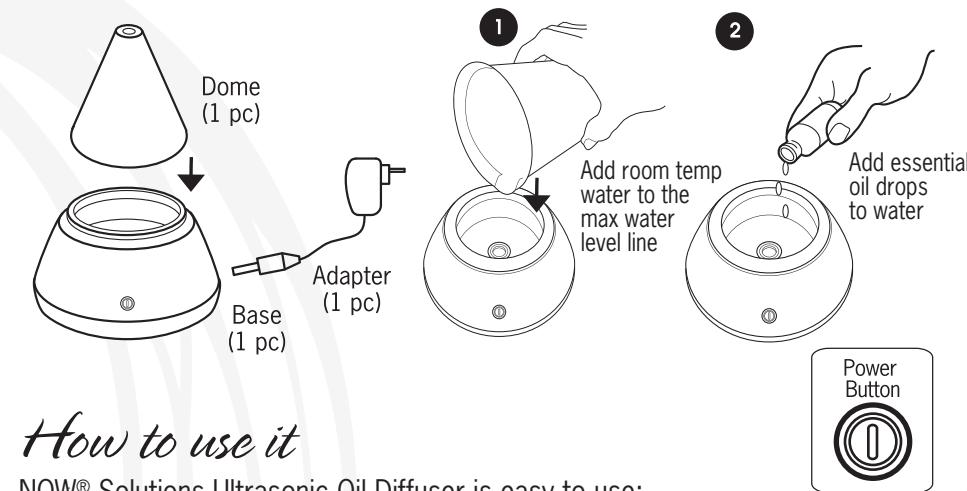

### How to use it

NOW® Solutions Ultrasonic Oil Diffuser is easy to use:

- Using your own cup, fill the base with room temperature (not cold) tap water up to the fill indicator arrow mark. **DO NOT OVERFILL.**
  - Do not use distilled or purified/filtered water.
  - Add essential oils directly into the water.
- Replace the dome. Plug in your unit and turn it on.

BUTTON PRESSED	MISTING	LIGHTS
Once	On	Rotating Colors
Twice	On	Color choice
Three Times	On	Off
Four Times	Off	Off

The unit will automatically shut off when the water level gets too low.

- That's it! Start enjoying the immediate healthful benefits your diffuser provides!  
NOTE: Oil mist can damage wooden and painted surfaces, wipe up any residue quickly and often.

### How to clean

We recommend that you clean your NOW® Solutions Ultrasonic Oil Diffuser every time you change oils. Oils are corrosive, and over time, they build up on the ceramic parts. To ensure long life for your diffuser, follow these simple steps:

- Rinse the water base with clean water and wipe dry with a clean cloth.
- Use a cotton swab to gently clean the Mist Disc and Sensor.

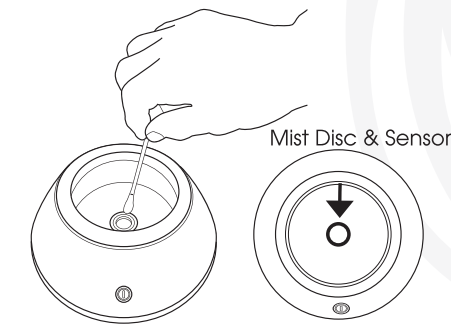

### Important note

If the unit is accidentally tipped over during operation, the water could flow into the inside chamber. Unplug the power and empty all of the water. Set it aside in a ventilated place for 3 days and reuse.

### Precaution

Please read the instructions carefully before using. Manufacturer accepts no liability for damage caused by incorrect use of the NOW® Solutions Ultrasonic Oil Diffuser.

Warning and cautions	No allowed actions	Strictly prohibited
⚠	⊘	⚡
1. Clean the unit when changing to a different oil.	2. Clean the unit by rinsing the water tank and wiping it dry with a clean cloth.	3. Do not use detergents, solvents or abrasive agents to clean the diffuser unit.
4. Shut off and unplug the power before cleaning.	5. Use the original adapter provided by the manufacturer.	6. If you don't use the device for a long time, unplug and pour water out.
7. Never use steamed water or very cold water. Never use corrosive solvent to clean product.	8. Never touch water level sensor and avoid product hitting other objects.	9. Never put your hand above the ceramic disc when product is working, as this could cause pain and damage the machine.
10. Never wrap the adapter with a cloth or paper, etc. Otherwise, it cannot dissipate heat normally and may cause deformation and burn the membrane from a short circuit. Never touch the adapter with wet hands.	11. Do not use other liquids except for water and drops of essential or fragrance oils.	12. Do not aim the device at walls, ceilings, or furniture surfaces as excess moisture could cause water damage.
13. Do not take this unit apart exposing electrical parts. Call customer service for assistance and guarantee information.	14. Never place on loose fabric that can block air flow and prevent the unit from misting and ventilating properly.	